

两相高性能混合式步进电机

TWO PHASE STEPPING MOTORS

步距精度	温升	环境温度	绝缘电阻	耐压	径向跳动	轴向跳动
Step Angle Accuracy	Temperature Rise	Ambient Temperature	Insulation Resistance	Dielectric Strength	Shaft Radial Play	Shaft Axial Play
5%	80°C Max	-20°C ~ +50°C	100MΩ Min (500VDC)	500V AC 1 Minute	最大0.02mm (450g负载)	最大0.08mm (450g负载)

● 机械尺寸图/DIMENSION: UNIT=MM

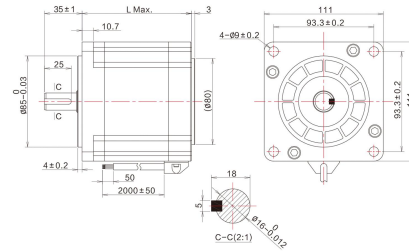

● 外观图/APPEARANCE



● 接线图/WIRING DIAGRAM

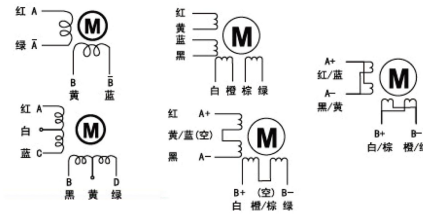

● 力矩曲线图/DYNAMIC TORQUE

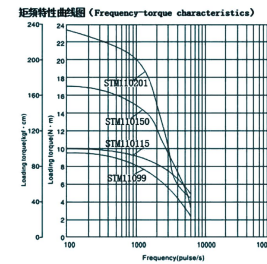

● 技术参数/TECHNICAL SPECIFICATIONS

型号	机身长度	步距角	电压	额定电流	电阻	电感	保持转矩	转子惯量	重量	轴径	轴伸(轴长)	键槽	匹配驱动器
Model	Length L (mm)	Step Angle (°)	Voltage (V)	Current (A/phase)	Resistance (Ω)	Inductance (mH)	Holding Torque (N.m)	Rotor Inertia (g.cm ²)	Weight (Kg)	Shaft Diameter (mm)	Axis Stretch (mm)	Keyway	Matching Driver
STM1099	99	1.8°	3.6	5	0.72	9.8	10	5500	5	16	38	4×4×25 (4线)	STD252M
STM10115	115		2.64	6	0.44	4.9	12	7500	6	16	38	4×4×25 (4线)	
STM10150	150		4.8	6	0.8	9.4	20	10900	8.4	16	38	4×4×25 (4线)	
STM10201	201		4.8	8	0.6	11	35	16200	11.7	16	38	4×4×25 (4线)	

备注：以上为常规性产品，轴径、轴长以及不同轴产品可根据客户需求定制。